

# Peebles

## Option 2: Haystoun Burn

### 200 Year Direct Defence

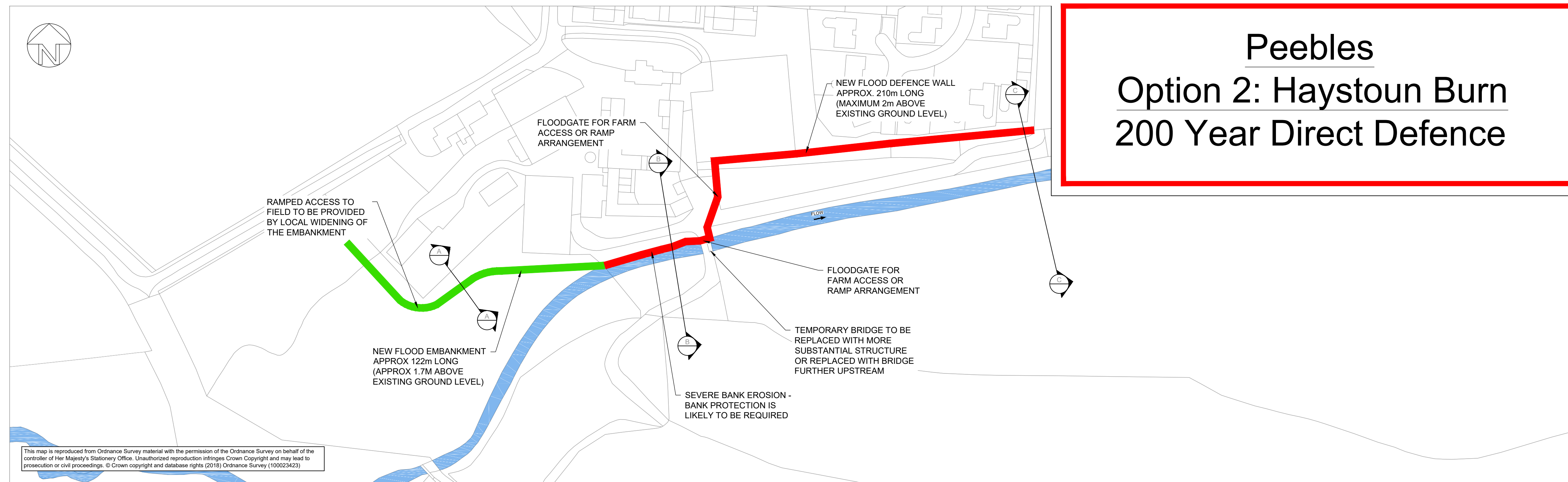

This map is reproduced from Ordnance Survey material with the permission of the Ordnance Survey on behalf of the controller of Her Majesty's Stationery Office. Unauthorized reproduction infringes Crown Copyright and may lead to prosecution or civil proceedings. © Crown copyright and database rights (2018) Ordnance Survey (100023423)

**OPTION SUMMARY:** Direct defences to the south of Whitehaugh Farm. Option provides a 1 in 200 year standard and cuts off key flow path from the burn to the north through the Kittlegairy Estate. Option provides protection to Whitehaugh Farm.

**LEGEND**

	200 Year water level
	Finished Ground Level
	Existing Ground Level
	Existing Watercourse
	Embankment
	Wall

**PLAN**  
1:1000

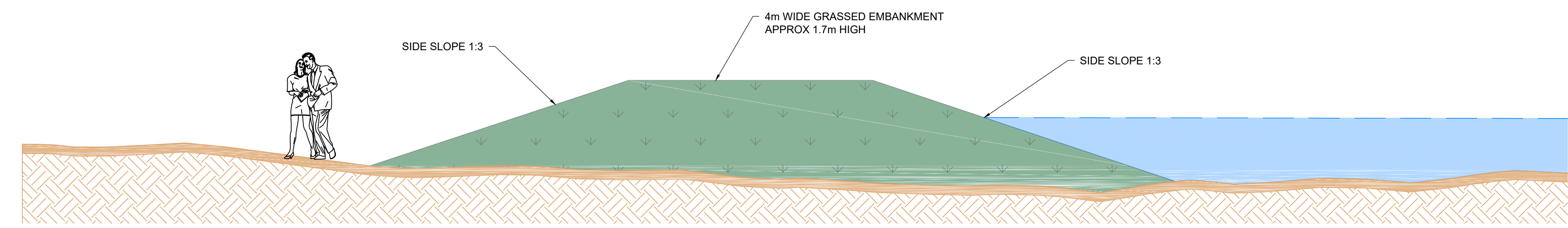

**SECTION A-A**  
1:50

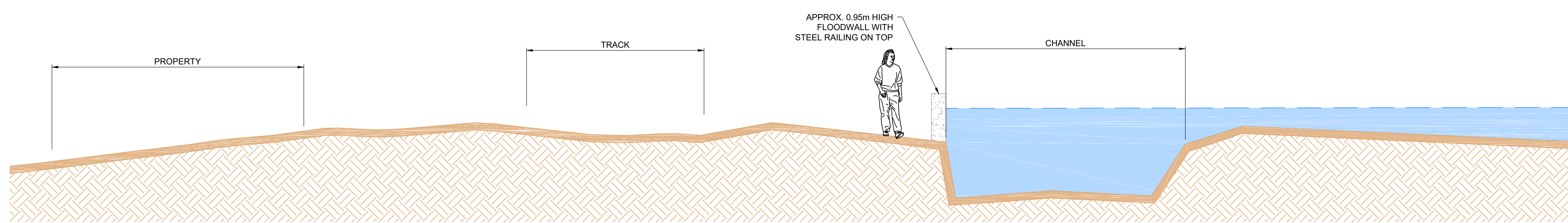

**SECTION B-B**  
1:50

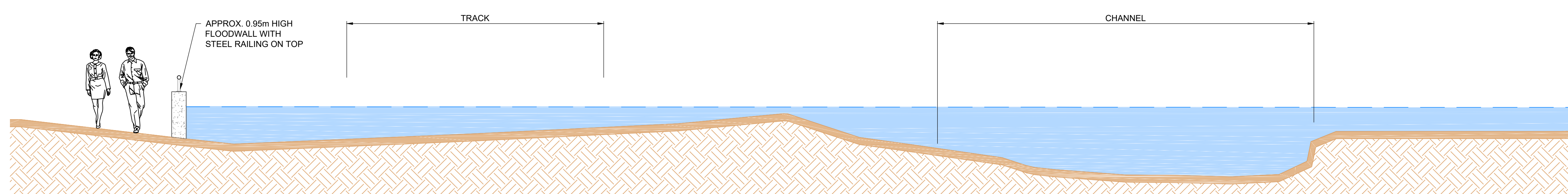

**SECTION C-C**  
1:50

Comments					
Rev.:	Date	Drawn	Designed	Checked	Approved
Client Approval					
A - Approved					
B - Approved with Revisions					
C - Do Not Use					
Purpose of Issue					Status
Suitable for Coordination					S1

**JBA consulting**

Unit 2.1  
Quantum Court  
Research Avenue South  
Heriot Watt University  
Edinburgh  
EH14 4AP  
United Kingdom  
www.jbaconsulting.com  
+44 (0)131 3192940  
+44 (0)845 8627772  
info@jbaconsulting.com

Offices at: Colshill, Doncaster, Edinburgh, Exeter, Glasgow, Haywards Heath, Isle of Man, Leeds, Limerick, Newcastle upon Tyne, Newport, Peterborough, Saltair, Skipton, Tadcaster, Thirsk, Wallingford and Warrington

Project	Borders Flood Studies		
Title	Peebles Haystoun Burn: Option 2 200 Year Direct defences		
Client	MOTT MACDONALD	Scottish Borders COUNCIL	

The property of this drawing and design vested in Jeremy Benn Associates Ltd. It shall not be reproduced in whole or in part, nor disclosed to a third party, without the prior written consent of Jeremy Benn Associates Ltd.

Scale	As Shown @ A1	Drawn:	A Coad	13/02/18
		Designed:	T Fletcher	12/02/18
		Checked:	A Pettit	12/02/18
		Approved:		

Project Number:	2017s5526	Revision	P02
Drawing Number	AEM-JBAU-PB-HB-JM-C-1200		